

NIKKEN

NIKKEN SEKKEI

WE ARE NIKKEN

Founded over 125 years ago, Nikken Sekkei has evolved alongside Japan's modernization. Our design processes are shaped by the unique conditions of Japan, including limited land area, frequent natural disasters, and seasonal climate variations. Today, we also address climate change and societal issues such as an aging population, declining birthrate, and densely populated urban areas.

Our experience in addressing these issues has led us to pursue eco-conscious designs and advanced technologies for a sustainable future. Drawing from our global project experience, our diverse team of experts collaborates to provide optimized solutions tailored to each client. We build trust through deep knowledge of local culture and regulations.

Our mission is to give shape to our clients' visions and make meaningful contributions to society. For every new challenge, we apply our professional expertise and innovative thinking to create sustainable urban environments for future generations.

We are a collective of architects,
designers and experts working across multiple disciplines.

MISSION 1	To achieve a better urban environment supporting the well-being of people through design
MISSION 2	To propose context-customized solutions and visionary designs
MISSION 3	To create timeless elegance and enduring value

OUR CORE VALUE

Philosophy of NIKKEN GROUP

We contribute to society through work that offers true value. With this as our core objective, we grow as individuals and develop as a worthy company.

Brand Tagline

EXPERIENCE, INTEGRATED

Integrating accumulated proficiency to deliver rich experiences.

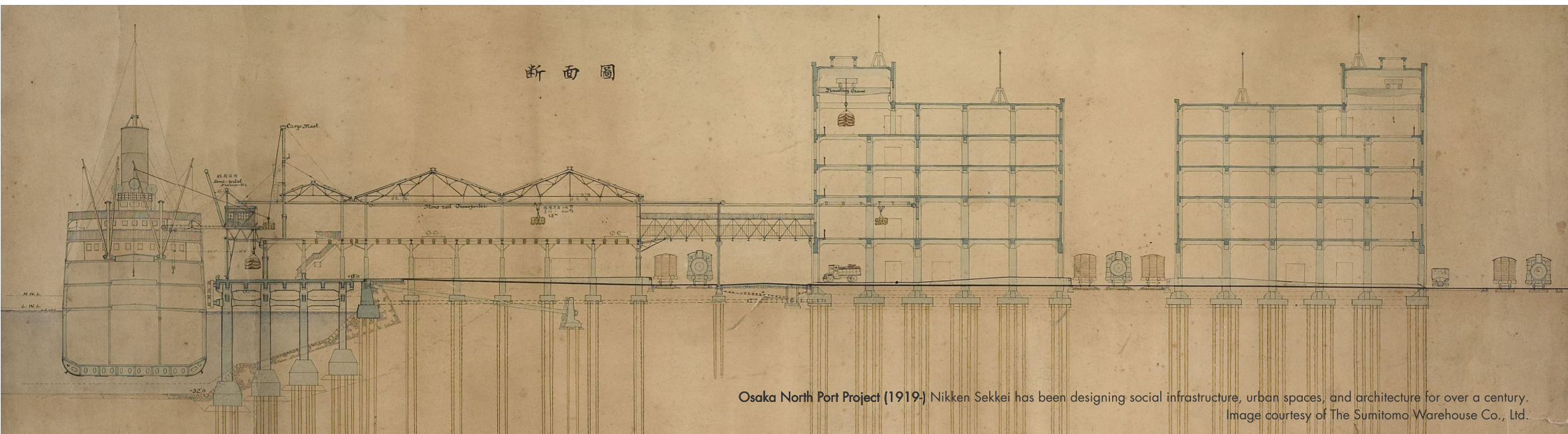

OUR EXPERTISE

<p>Architectural Design</p> <p>We aim to provide a total holistic multi-disciplinary design service.</p>	<p>Interior Design</p> <p>When designing interior space, we believe that it is extremely important to emphasize not only aesthetics and decorativeness, but also to pursue functionality.</p>	<p>Structural Engineering</p> <p>Structural design is the key to safety in the creation of any building. We have constantly realized state-of-the-art structural design by developing and implementing cutting-edge technologies.</p>	<p>MEP Engineering</p> <p>Having MEP engineers in-house also promotes sustainability by giving us more control over life-cycle costing (LCC), an increasingly critical consideration for any architectural project.</p>	<p>Computational Design & BIM</p> <p>We are constantly working on providing the best service framework in the ICT age in order to cope with the increasingly complex large-scale buildings and intricate developments.</p>	<p>Urban Design and Planning</p> <p>We draw on the broad in-house resources of planners, urban designers, architects, engineers and landscape specialists to provide integrated solutions focused on environmental and economic sustainability, functionality and visionary appeal.</p>
<p>Civil Engineering</p> <p>We have an extensive track record and experience in planning and designing urban infrastructure facilities.</p>	<p>Landscape Design</p> <p>Aesthetically pleasing outdoor spaces — public and private— serve to visually enhance the immediate surroundings and improve quality of life in the community.</p>	<p>Sustainability / Resilience</p> <p>Sustainability increases environmental resilience and is also important to protect people from risks such as natural disasters.</p>	<p>Management</p> <p>We ensure smooth project progression through services such as corporate real estate consulting, large-scale development management, project management, and construction management for design-build delivery.</p>	<p>Behavioral Design</p> <p>We propose diverse solution—from buildings and spaces to systems and processes—that help to shape the behavior of employees, citizens, and consumers according to the vision of our clients and society.</p>	

*Content may vary by country or region.

OUR APPROACH

Responding to modern societal needs

We contribute to society through projects that meet the expectations of today and aspirations of tomorrow

Nikken Sekkei engages in projects designed to meet modern needs. We conduct extensive R&D to acquire knowledge that fosters creative ideas and innovative technologies. We are constantly learning as we contribute to society, enhancing our expertise as a firm and developing new applications of that know-how. This consistent approach to diversifying needs enables Nikken Sekkei to grow with the times alongside clients around the world.

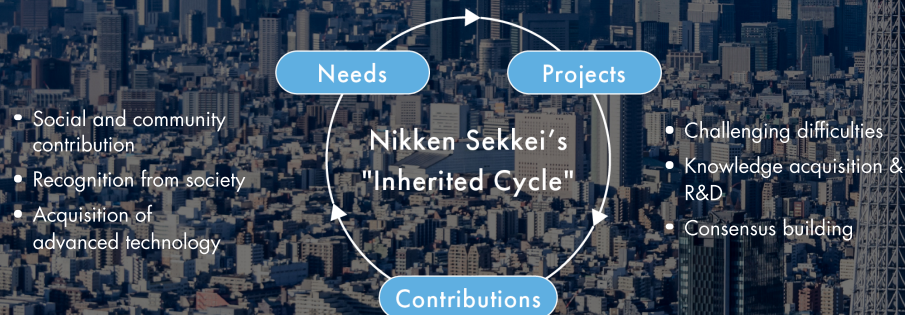

1 From Sustainable to Regenerative

2 Designing the City of the Future

3 Creating Public Spaces that Foster Community Development

4 Connecting the Past and the Future

5 Transit-Oriented Development

6 Utilizing Disaster Experience

7 Making City Icons with Unique Features

© TOKYO-SKYTREETOWN

ENVIRONMENTAL INITIATIVES

#01 Nikken Sekkei's attitude toward the environment

Environmental Policy of Nikken Sekkei

Nikken Sekkei is committed to conserving and improving the environment with a proper understanding of the expectations of our clients and society.

- 1 We will strive to reduce the environmental impacts of our business activities and improve the environmental performance of cities and buildings based on ongoing quantitative monitoring of energy and resource use.
- 2 We will strive to proactively inculcate our collective intelligence on sustainability both inside and outside the company as professionals of architecture and urban design.
- 3 We will strive to comply with and continuously improve our Environmental Management System (EMS)* for individual and company development and to contribute to our clients and to society at large.

* (EMS): a framework of requirements that enable an organization to reduce its environmental impact and increase operating efficiency based on ISO 14001 standards.

● Climate Emergency Declaration (2021)

Nikken Sekkei declared a climate emergency in 2021, calling on our clients and society to seek a balance between economic activity and carbon neutrality in working styles and urban and architectural design.

● Endorsement of TCFD (2022 –)

We align with the TCFD (Task Force on Climate-related Financial Disclosures) recommendations and disclose information via our sustainability report.

● Targeting carbon neutrality

Nikken Sekkei supports our clients' carbon-neutral strategies as we aim to achieve net-zero CO₂ emissions in our business activities. We propose seven initiatives, including the reduction of operational and embodied carbon, as well as the dissemination of environmental performance evaluation systems.

ENVIRONMENTAL INITIATIVES

#02 Examples of sustainability-focused projects

1 Human-oriented architecture

JR Kumamoto Station Building

- Biophilic design that appeals to all senses
- Provides for comfort through simulations using light, airflow and temperature, and verification of operation

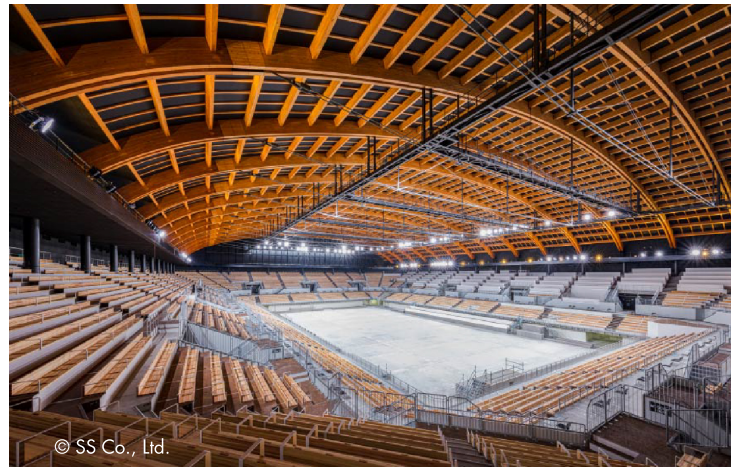
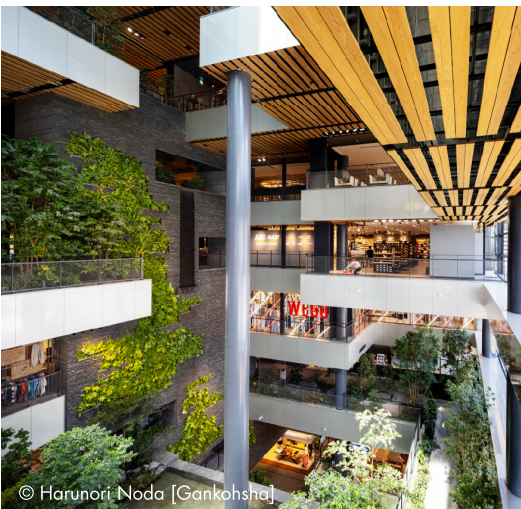

2 Promoting a circular economy

Ariake Gymnastics Centre(Ariake GYM-EX)

- Use of 2,300m² of timber (largest amount for a Tokyo 2020 venue)
- 10% upfront carbon reduction compared to a steel-framed facility
- 90m-span large structure with solid cedar wood seating for 12,000
- Computational design of airflow and thermal environment

3 Technological innovation for resilience

Grand Green Osaka

- Japan's first aquifer thermal energy storage system using the National Strategic Special Zone Program
- First private-sector use of a sewerage heat recovery system in Osaka City



Regenerative Tree



ENVIRONMENTAL INITIATIVES

#03 From sustainable to regenerative

The “Regenerative Tree” prototype, announced by Nikken Sekkei in May 2024, represents a pioneering approach to next-generation skyscrapers, introducing a range of workplace design innovations aimed to adapt to diverse work styles and reduce whole life carbon (WLC) emissions. Featuring an efficient steel-wood hybrid structure, a transport system using express elevators and escalators, diverse shared spaces, and MEP design inspired by biomimicry, this prototype is designed for Tokyo, but adaptable worldwide. We are actively collaborating with clients to implement this concept.

Key Design Features

1. Efficient steel-wood hybrid structure
2. Transport system using express elevators and escalators
3. Diverse shared spaces
4. MEP design inspired by biomimicry

HERITAGE; SINCE 1900

Founded in 1900, 26 professionals embarked on a journey. This was a time when Japan was rapidly pressing forward with modernization. Nikken Sekkei also was beginning to acquire the architectural styles and techniques of the west. This "pursuit of technology" went on to become an embedded basic principle in the firm.

The environmentally conscious design ethos evident in its very first project, incorporating natural day lighting and long building life, endures to this day.

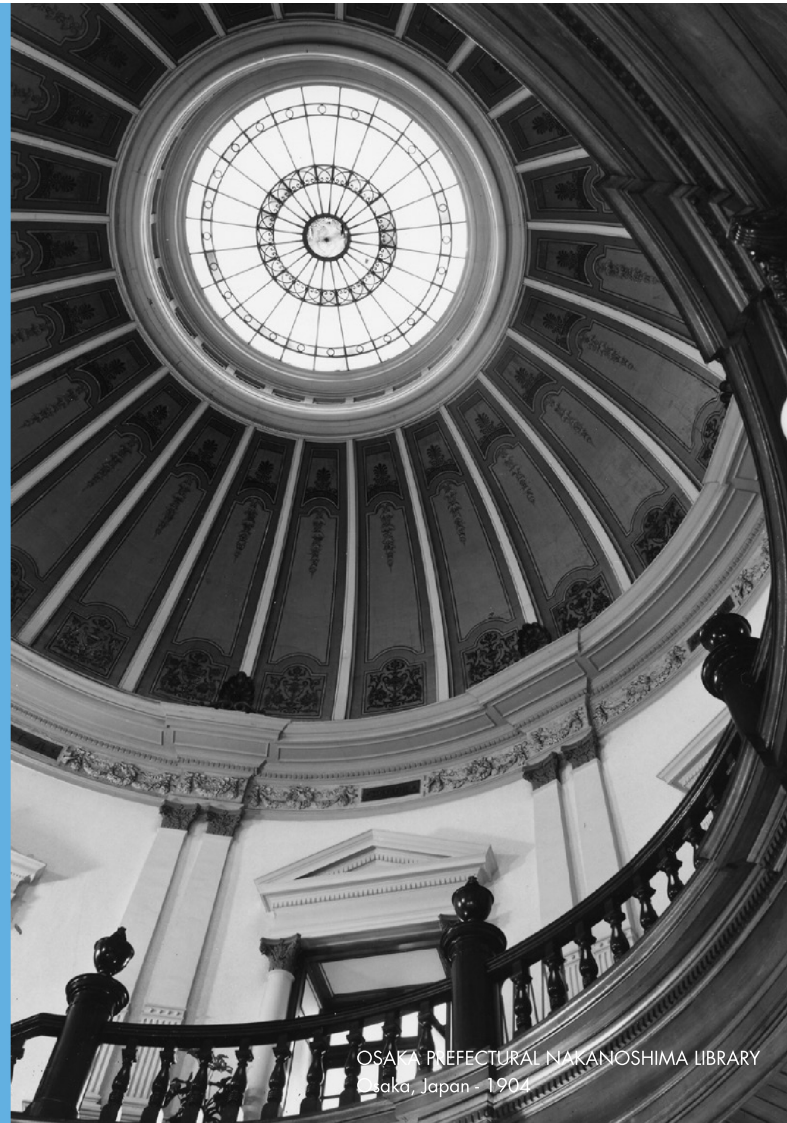

OSAKA PREFECTURAL NAKANOSHIMA LIBRARY
Osaka, Japan - 1904

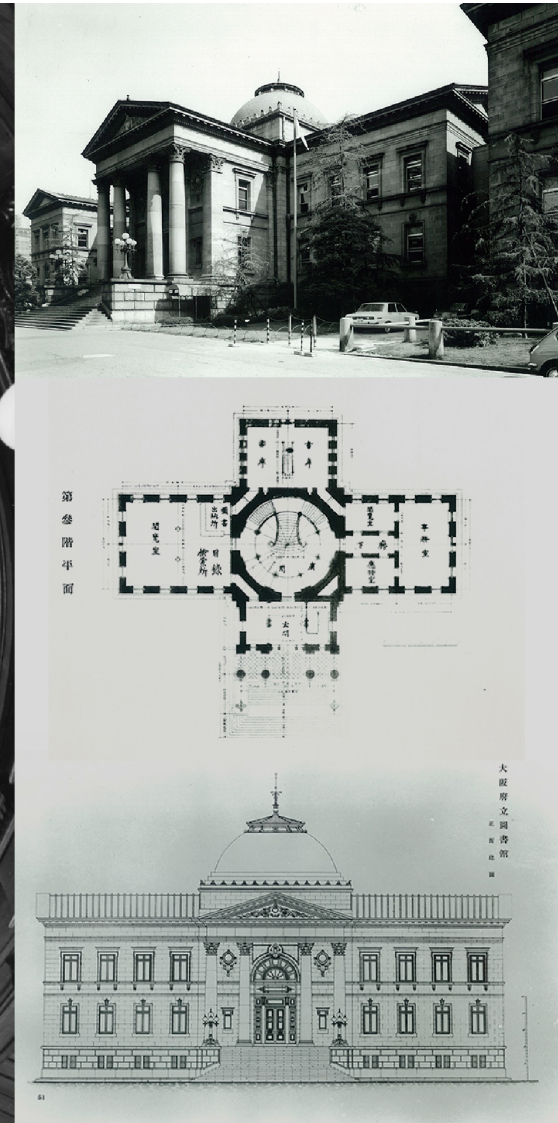

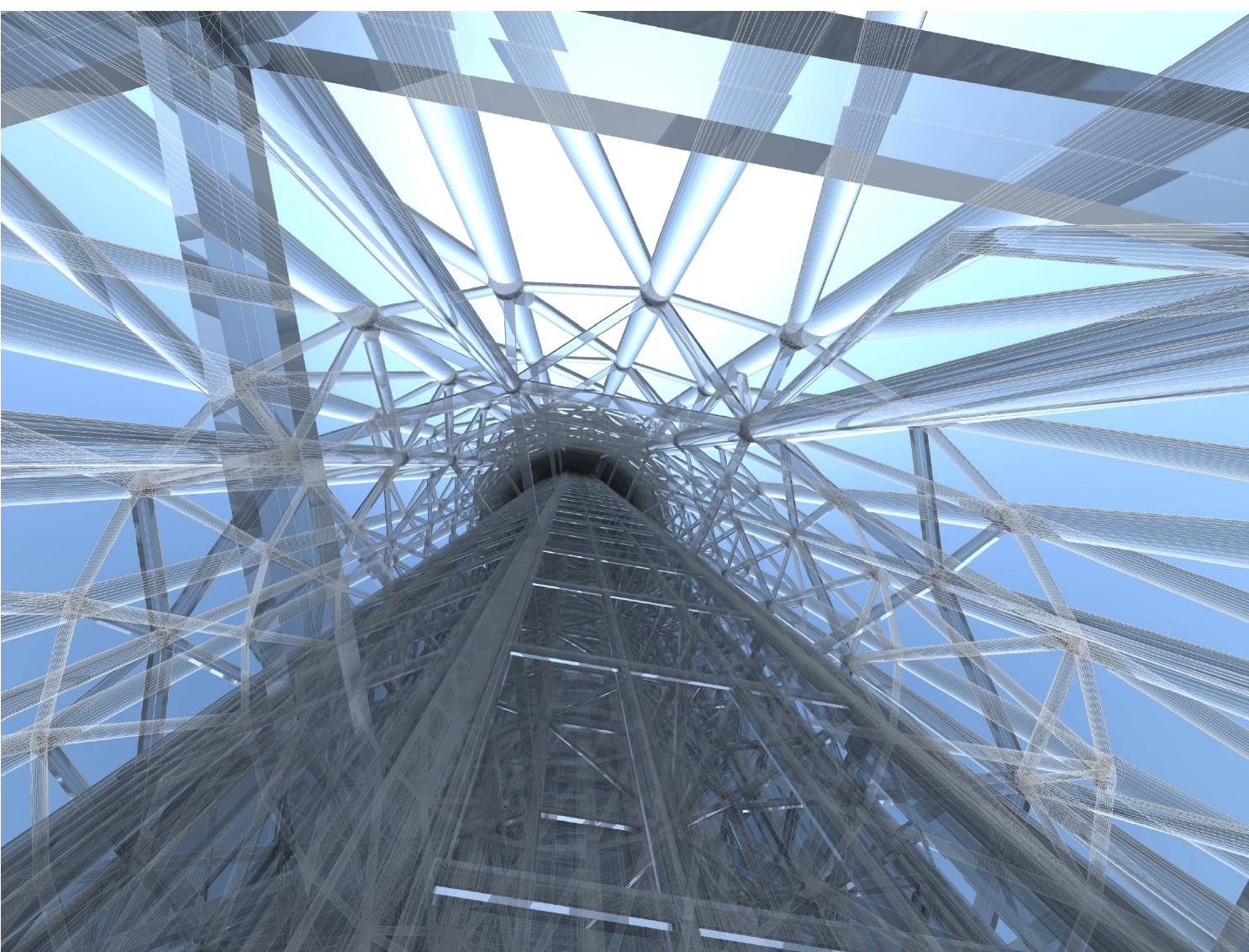

SELECTED WORKS

Nikken Sekkei has over 125 years of history.

Still, we are constantly striving to create new value
to meet new demands.

The World's Tallest Tower

TOKYO SKYTREE

Tokyo, Japan, 2012 - Tall Buildings

Site area As TOKYO SKYTREE TOWN
: 36,844.39 sq.m

Total floor area As TOKYO SKYTREE TOWN
: 229,728.92 sq.m

Building height 634.00 m

2015 - AJI Awards

2011 - GUINNESS WORLD RECORDS™ as the World's
Tallest Tower



© TOKYO SKYTREETOWN

Realizing Urban Space as a "City Within a Park"

GRAND GREEN OSAKA

Site area 91,158.23 sq.m
Total floor area 45,000.00 sq.m

Osaka, Japan, 2027 (Scheduled) - Mixed Use/TOD



Co-architect : Mitsubishi Jisho Design, Obayashi Corporation, Takenaka Corporation, Nikken Housing System, SANAA, Tadao Ando
Co-designer : GGN, Uchiyama Creative Lighting Design, Rian Ihara Design Office, MEC Design International,

© Akira Ito [aifoto]

An Elegant Symbol for the Skyline of Dubai

ONE ZA'ABEEL

Dubai, UAE, 2024 - Mixed Use/TOD

Site area 31,100.00 sq.m
Total floor area 530,700.00 sq.m
Building height 305.00 m

2024 - CTBUH Awards

2024 - International High-Rise Awards

2024 - AIA Middle East Awards



A Symbolic Design that Clearly Reflects the Device's Characteristics

3GeV SYNCHROTRON RADIATION FACILITY NanoTerasu

Sendai, Japan, 2022

Site area 646,935.60 sq.m
Total floor area 25,357.81 sq.m
Building height 9.45 m

2023 - JIA 100 Selected Works



© Kunihiko Ishijima

A Wooden Vessel Floating in the Bay Area

ARIAKE GYMNASTICS CENTRE

Tokyo Japan, 2019 - Cultural/Sports

Site area 93400.00 sq.m

Total floor area 39,194.30 sq.m

Building height 30.00 m

2022 - ARCASIA Awards

2021 - World Architecture Festival Engineering Prize

2021 - IOC IPC IAKS Architecture Prizes



Co-designer : Shimizu Corporation(Engineering adviser : Masao Saitoh) (Developed Design)

© SS Co., Ltd.

Connecting the City Divided by the Railway with a Multi-Level Ring Road

GUANGZHOU BAIYUN RAILWAY STATION TOD

Guangzhou, China, 2023 - Mixed Use/TOD

Site area 213,700.00 sq.m
Total floor area 452,450.00 sq.m
Building height 39.70 m
Co-architect China Railway Siyuan Survey and Design
Group Co., Ltd.
Architectural Design & Research Institute of
SCUT Co., Ltd.
Guangzhou Urban Planning & Design
Survey Research Institute Co., Ltd.

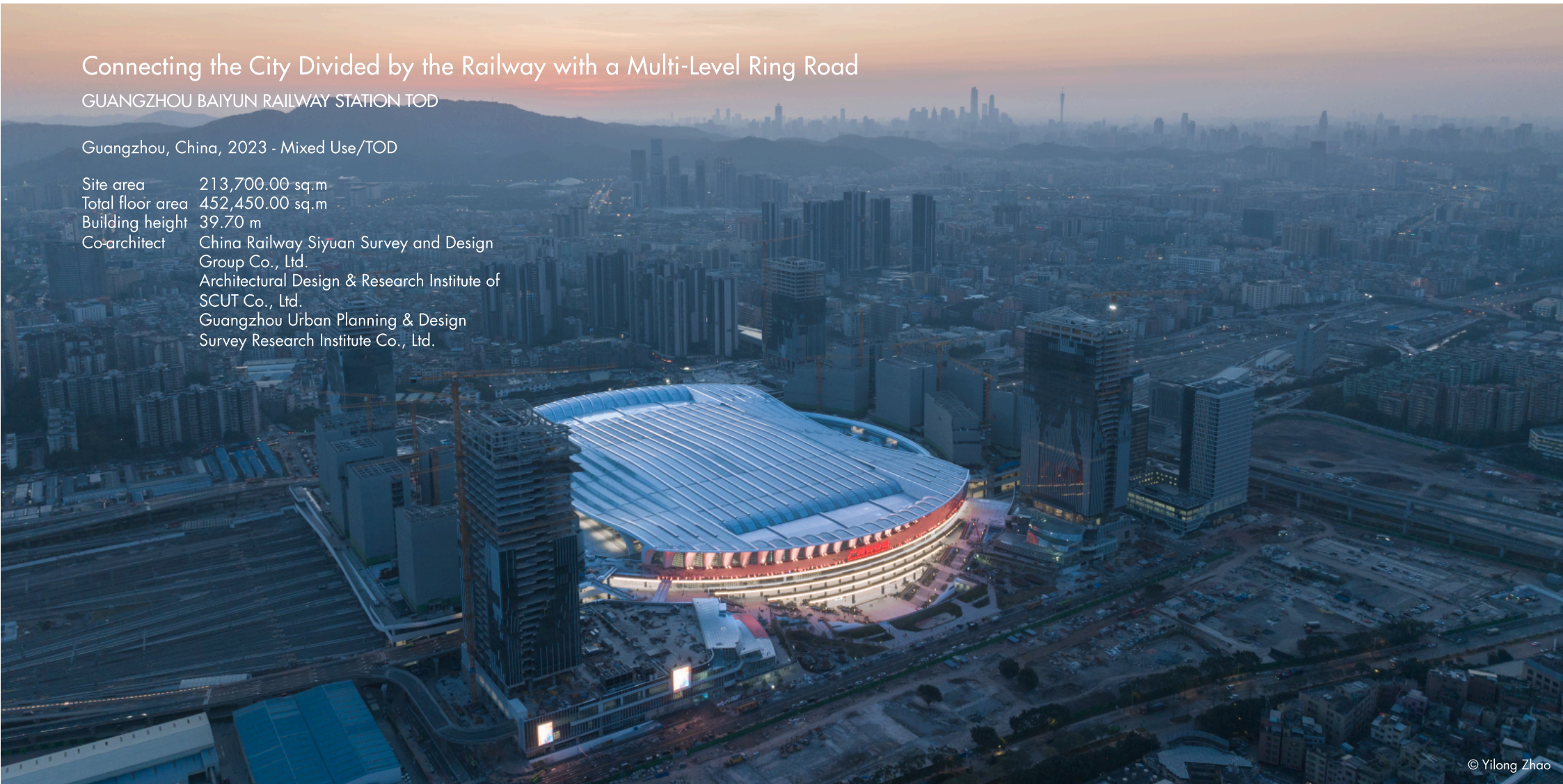

© Yilong Zhao

Condominium Hotel as a Housing Complex in Harmony with the Landscape

MUWA NISEKO

Hokkaido, Japan, 2023 - Hospitality

Site area 6,440.00 sq.m
Total floor area 20,817.00 sq.m
Building height 25.52 m



© Forward Stroke inc.



R&D Office Designed with CUBE, VOID, and GRID

HD HYUNDAI GLOBAL R&D CENTER (GRC)

Seongnam, South Korea, 2023

Site area 25,068.10 sq.m

Total floor area 175,751.38 sq.m

Building height 99.87 m

Co-architect Heerim Architects & Planners Co., Ltd.

2024 - CTBUH Awards





Beacon for the Economy of the Middle East

TADAWUL TOWER

Riyadh, Kingdom of Saudi Arabia, 2022 - Tall Buildings

Site area 5,200.00 sq.m
Total floor area 145,000.00 sq.m
Building height 200.00 m

2024 - International Architecture Awards

2023 - CTBUH Awards

2013 - International Property Awards



High-Rise for the New Age Connects Town, Environment, and Art

MUSEUM TOWER KYOBASHI / ARTIZON MUSEUM

Tokyo, Japan, 2019 - Mixed Use/TOD

Site area 2,813.74 sq.m
Total floor area 41,829.51 sq.m
Building height 149.56 m

2022 - International Architecture Awards
2021 - ARB LEAF Awards
2020 - CTBUH Awards



Embodying Tradition and Innovation

SUZHOU MODERN MEDIA PLAZA

Suzhou, China, 2016 - Mixed Use/TOD

Site area 37,749.00 sq.m
Total floor area 323,724.00 sq.m
Building height 214.80 m
Co-architect ARTS Group Co., Ltd.

2018 - Annual AJJ Architectural Select Design Prize





Skyscraper Re-Innovation

SHINJUKU SUMITOMO BUILDING

Tokyo, Japan, 2020 - Tall Buildings

Site area 14,446.00 sq.m
Total floor area 180,195.00 sq.m
Building height 211.35 m
Co-designer Sumitomo Realty & Development (Basic plan and general supervision), Taisei Design Planners Architects & Engineers(Construction drawings and supervision)

2021 - CTBUH Renovation Award

2021 - MIPIM Asia Awards



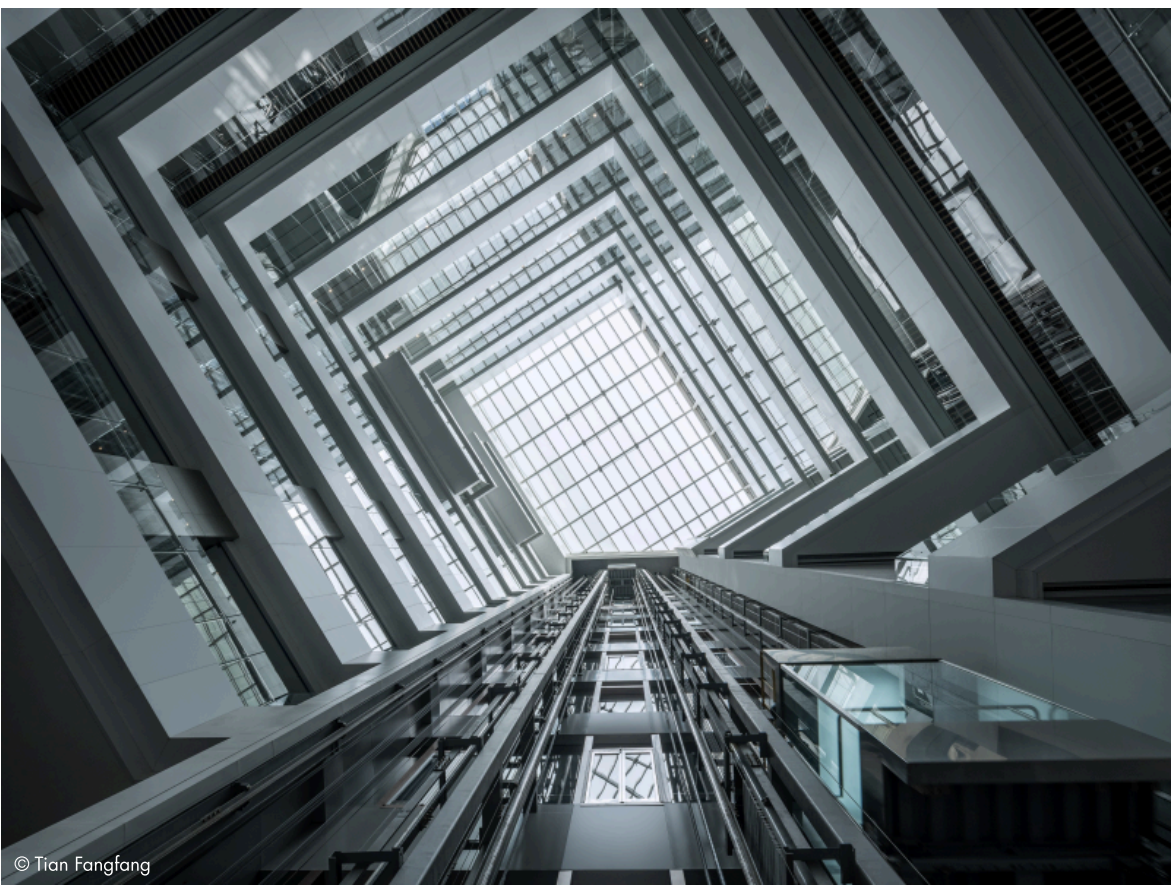

Major Renewal Project Pioneering a Decarbonization Society

DINGHAO ELECTRONICS BUILDING UPGRADING AND RENOVATION PROJECT[PHASE1]

Beijing, China, 2021 [Phase 1] - Office

Site area	Total of phases 1 + 2 : 15,787.07 sq.m
Total floor area	Total of phases 1 + 2 : 186,821.60 sq.m
Building height	Phase 1 : 90.00 m
Co-architect	Victory Star

2024 - ULI Asia Pacific Awards for Excellence
2023 - World Architecture Festival: Beijing High-Tech Landmark
2023 - MIPIM Asia Awards: Best Refurbished Building



A Constantly Evolving, Eternally Unfinished Work of Architecture

NARITA INTERNATIONAL AIRPORT TERMINAL 3

Chiba, Japan, 2015 - Aviation/Transportation

Site area 13,702,589.17 sq.m
Total floor area 62,281.22 sq.m
Building height 19.95 m
Co-designer PARTY, Ryohin Keikaku Co., Ltd.

2016 - Cannes Lions
2015 - Good Design Award
2015 - SDA Award





Once-a-Century Urban Redevelopment

SHIBUYA STATION AREA REDEVELOPMENT

Tokyo Japan, 2027 (Scheduled) - Mixed Use/TOD

- 2012 Shibuya Hikarie
- 2018 SHIBUYA STREAM
- 2019 Shibuya Scramble Square the First Phase (East Tower)
- 2019 Shibuya Fukuras
- 2023 Shibuya Sakura Stage
- 2027 Shibuya Scramble Square the Second Phase (Scheduled)
(Central and West Towers)



Design to Connect the Super High-Rise and the City Below

SHIBUYA SCRAMBLE SQUARE THE FIRST PHASE (EAST TOWER)

Tokyo, Japan, 2019 - Mixed Use/TOD

Site area	Including the Second Phase for Central and West Towers: 15,275.55 sq.m
Total floor area	181,000.00 sq.m
Building height	229.70 m
Collaborator	Design Architects: Nikken Sekkei and Kengo Kuma and Associates Basic design and supervision: Shibuya Station District Development Project Consortium (Nikken Sekkei + Tokyu Architects & Engineers + JR-East Design Corporation + Metro Development)

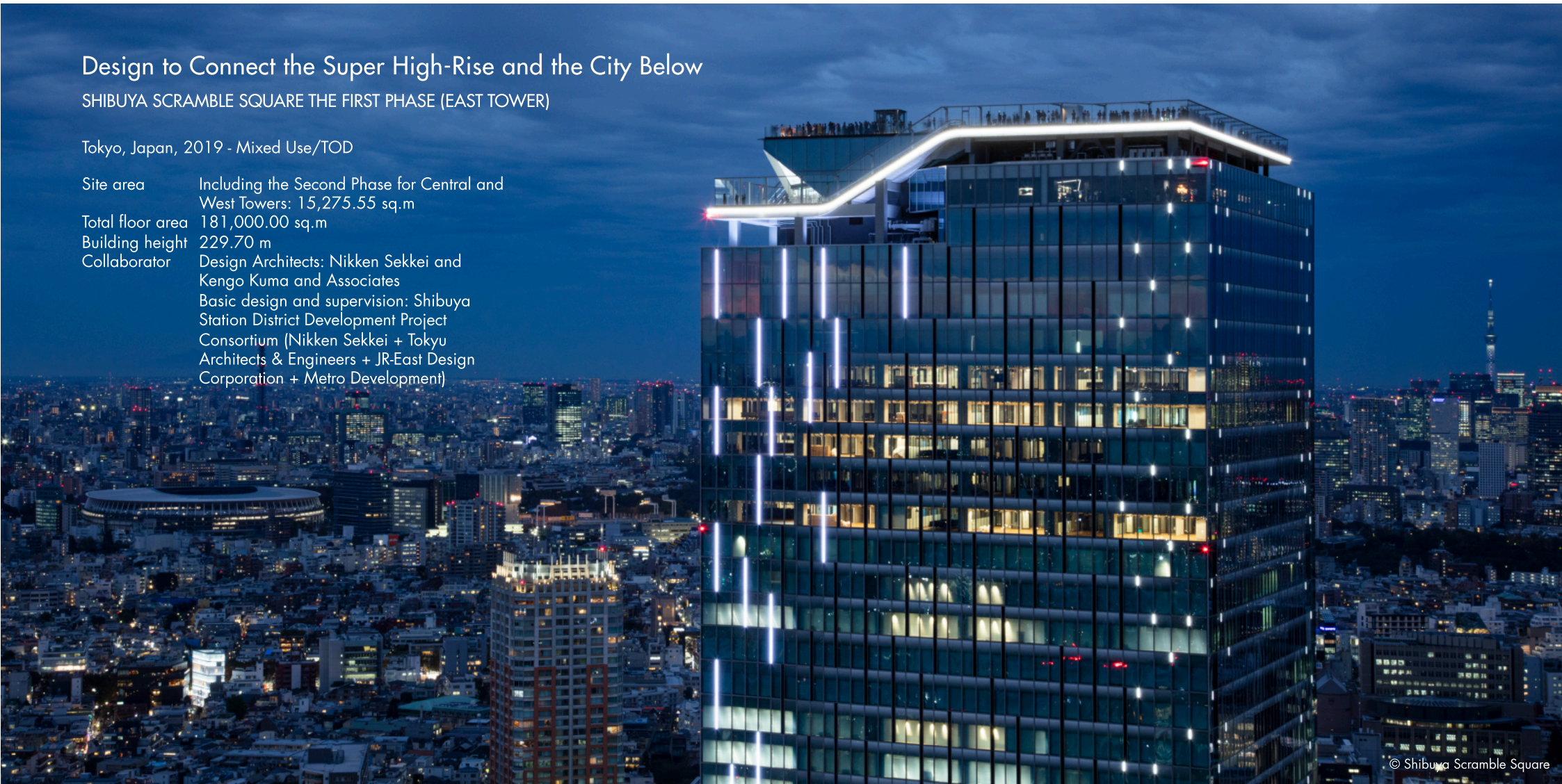

© Shibuya Scramble Square

A New Landmark for Tokyo's Main Gateway

TOKYO STATION YAESU DEVELOPMENT - GRANROOF

Tokyo, Japan, 2013 - Mixed Use/TOD

Site area GranRoof+GranTokyo North Tower
: 14,439.18 sq.m

Total floor area GranRoof: 14,144.79 sq.m

Building height 27.00 m

2017 - ARCASIA Awards for Architecture

2016 - Annual AJJ Architectural Select Design Prize

2016 - JIA 100 Selected Works





A Modern Metro Hub Blending Innovation, History, and Future Connectivity

BEN THANH CENTRAL STATION
OPERA HOUSE STATION
BA SON STATION

Ho Chi Minh City, Vietnam, 2024 - Mixed Use/TOD

Site area	Ben Thanh Station: 36,867.00 sq.m Opera House Station: 28,720.00 sq.m Ba Son Station: 14,859.00 sq.m
Co-designer	Nippon Koei, Meinhardt, Yooshin, AECOM



Guest House to Suit the Ancient Capital

THE RITZ-CARLTON KYOTO

Kyoto, Japan, 2013 - Hospitality

Site area 5,937.28 sq.m
Total floor area 24,682.89 sq.m
Building height 17.43 m

2016 - BCS Award

2016 - Annual AIJ Architectural Design Encouragement Prize



New Public Space Integrating Park and Commerce

MIYASHITA PARK

Tokyo, Japan, 2020 - Commercial/Retail

Site area 10,740.47 sq.m
Total floor area 46,000.00 sq.m
Building height 75.10 m
Collaborator Lead Architect: Takenaka Corporation
Project Architect: Nikken Sekkei

2024 - BCS Prize

2023 - ARCASIA Awards for Architecture

2021 - JIA Outstanding Environmental Architecture Award

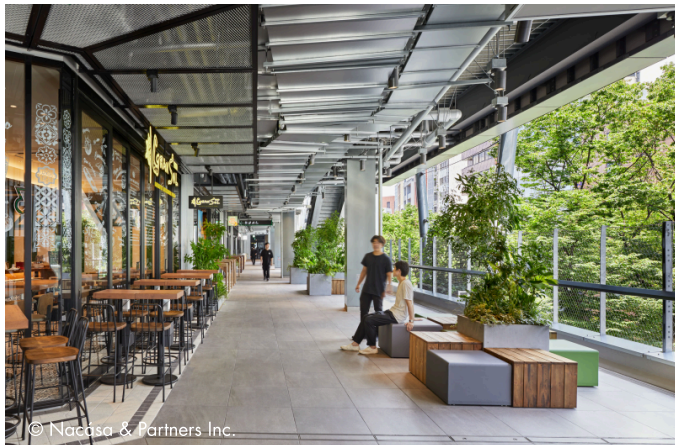

Experiencing the Grandeur of Kumamoto's Natural Beauty through Biophilic Design

JR KUMAMOTO STATION BUILDING

Kumamoto, Japan, 2021 - Mixed Use/TOD

Site area 19,945.97 sq.m
Total floor area 110,028.48 sq.m
Building height 59.41 m
Co-designer Sirius Lighting Office (Lighting Design)
Nippon Design Center, Inc.,
Irobe Design Institute (Signage Design)

2024 - CTBUH Awards
2022-2023 9th CREDAWARD
2022 - MIPIM Asia Awards





A New Way to Co-create City and Culture Through a Commercial Landmark

TOKYU PLAZA HARAJUKU "HARAKADO"
Jingumae 6 Urban Redevelopment Project

Tokyo, Japan, 2023 - Commercial/Retail

Site area 3,084.54 sq.m
Total floor area 19,893.74 sq.m
Building height 46.40 m
Collaborator Nikken Sekkei (Architect); Akihisa Hirata Architecture Office (Facade and rooftop designer); Nomura (Commercial environment design); Nikken Sekkei and Maio Architects (Design management); Izumi Okayasu Lighting Design Office (Lighting designer)

2024 - Good Design Award



New Lifestyle Hub

TOKYO MIDTOWN

Tokyo, Japan, 2007 - Mixed Use/TOD

Site area 68,891.63 sq.m
Total floor area 563,801.02 sq.m
Building height 248.10 m

2010 - Sustainable Architecture Prize
2008 - BCS Award
2007 - MIPIM Asia Awards



An Integrated City of Above Ground and Underground Where Media and Culture Intersect

SHANGHAI WEST BUND MEDIA PORT

Shanghai, China, 2020 - Mixed Use/TOD

Site area	198,819.00 sq.m
Total floor area	998,883.95 sq.m
Building height	150.00 m
Co-architect	Huajian Group Shanghai Architectural Design and Research Institute Co., Ltd

2024 - Sustainable Development Goals
2018 - LEED-ND v2009 / Gold
2017 - Shanghai Intelligent Building Exemplary Project



An Advanced Market that Enhances the Appeal of Tokyo as a World-Class City

TOYOSU MARKET (TOKYO CENTRAL WHOLESALE MARKET)

Tokyo, Japan, 2016

Site area 388,521.30 sq.m
Total floor area 560,168.64 sq.m
Building height 41.84 m



“Industry 4.0” Factory for Reindustrialization in Hong Kong

ADVANCED MANUFACTURING CENTRE

Hong Kong, China, 2022

Site area 27,145.00 sq.m
Total floor area 108,580.00 sq.m
Building height 70.00 m
Co-designer Wong Tung & Partners Ltd. (Lead
Architectural Consultant)

2023 - Urban Design & Architecture Awards
2022 - Global Future Design Awards
2020 - Rethinking The Future Awards





Environment for ZEB (Zero-Energy Building) and Collaborative Creativity Innovation

DAIKIN TECHNOLOGY AND INNOVATION CENTER

Osaka, Japan, 2015

Site area 396,666.66 sq.m

Total floor area 47,911.86 sq.m

Building height 31.43 m

Co-architect NTT FACILITIES, INC.

2018 - Energy Conservation Grand Prize

2018 - ASHRAE Regional Technology Awards

2016 - LEED-NC v2009 / Platinum

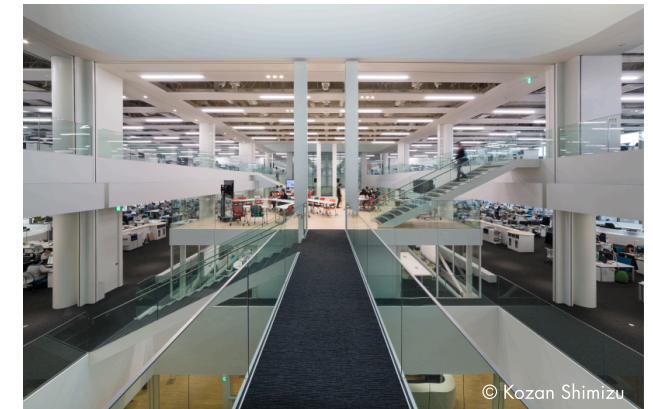

Open to the City, Bringing Citizens Together
SPOTIFY CAMP NOU

Co-architect
b720 Fermín Vázquez Arquitectos,
IDOM, Pascual-Ausió Arquitectes

Barcelona, Spain, 2026 (Scheduled) - Cultural/Sports





Defying Gravity

HOKI MUSEUM

Chiba, Japan, 2010 - Cultural/Sports

Site area 3,862.72 sq.m
Total floor area 3,722.39 sq.m
Building height 7.06 m

2012 - JIA Grand Prix

2011 - Japan Lighting Award

2011 - Japan Association of Artists, Craftsmen, and Architects Prize



© Harunori Noda [Gankohsha]

Public Architecture in a Park

TAKATSUKI ARTS THEATRE

Osaka, Japan, 2023 - Cultural/Sports

Site area 19,075.80 sq.m
Total floor area 17,273.65 sq.m
Building height 31.29 m

2025 - AIJ Awards
2024 - BCS Prize
2023 - JIA Architect of the Year



Unfolding Space

GUANGZHOU LIBRARY

Guangzhou, China, 2012 - Cultural/Sports

Site area	21,067.39 sq.m
Total floor area	98,008.50 sq.m
Building height	50.00 m
Co-architect	Guangzhou Design Institute





Building as a Promenade

AMAKUSA COMPLEX "KOKORASU"

Kumamoto, Japan, 2020 - Cultural/Sports

Site area 20,115.18 sq.m
Total floor area 5,452.87 sq.m
Building height 12.80 m
Co-architect Takt Project

2023 - Japan Federation of Architects and Building Engineers
Associations Prize
2023 - JSCA Award
2020 - Award for Good Quality Wood-Utilizing Architecture



Creating a Sence of Continuity and Openness

TOHO GAKUEN SCHOOL OF MUSIC

Tokyo, Japan, 2014 - Education

Site area 3,305.22 sq.m

Total floor area 5,828.91 sq.m

Building height 11.30 m

2019 - AIJ Awards

2016 - ARCASIA Awards for Architecture

2015 - World Architecture Festival Awards





Modern Science Comes Naturally

OKINAWA INSTITUTE OF SCIENCE AND TECHNOLOGY

Okinawa, Japan, 2010 - Education

Site area	366,491.94 sq.m
Total floor area	56,605.83 sq.m
Building height	27.14 m
Co-architect	Kornberg Associates Architects, Kuniken Ltd.

2012 - Annual AIJ Architectural Select Design Prize

2011 - JIA 100 Selected Works



A Hospital Deep in Nature Helping Kids Grow

TOKYO METROPOLITAN TAMA MEDICAL CENTER
TOKYO METROPOLITAN CHILDREN'S MEDICAL CENTER

Tokyo, Japan, 2009 - Healthcare

Site area 144,364.43 sq.m

Total floor area 129,879.40 sq.m

Building height 56.90 m

2011 - Healthcare Architecture Award

2010 - Sustainable Design Prize



© Hiroshi Shinozawa

A Perinatal Hospital with a “Japan Retro” Feel

JAPANESE RED CROSS TOKYO KATSUSHIKA PERINATAL CENTER

Tokyo, Japan, 2021 - Healthcare

Site area 7,040.43 sq.m
Total floor area 10,323.94 sq.m
Building height 22.89 m



© SS Co., LTD.

Where nature meets design

ECOPARK-THE LANDMARK & SWANLAKE RESIDENCES

Hanoi, Vietnam, 2023 - Residential

Site area 40,045.00 sq.m
Total floor-area 280,315.00 sq.m
Building height 150.00 m
Co-designer Vietnam Investment Consulting and
Construction Design Joint Stock Company



© COTECCONS

An Oriental Aesthetic Resort
that Combines Grandeur and Delicacy
BEIJING XITAN HOTEL LANDSCAPE DESIGN

Beijing, China, 2022, 2024 - Hospitality

Site area 21,000.00 sq.m
Total floor area 13,000.00 sq.m
Co-designer Nomura Landscape Laboratory

2024-Selected Landscapearchitectural Designs of the JILA
2023-AHEAD AWARDS AISA
2023-IFLA ASIA-PAC LA AWARDS

© NIKKEN SEKKEI LTD



Reuniting Neighbourhoods with Public Space THE RAIL CORRIDOR

Singapore, 2017 - Urban Design/Master Plan

Site area (Master Plan) 240,000.00 sq.m
(Bukit Timah Node) 43,000.00 sq.m
Total floor area (Bukit Timah Railway Station and the
Railway Staff Quarters) 380.00 sq.m



Source: Nikken Sekkei

OUR GLOBAL REACH

17 locations in 7 countries



as of January, 2025

INFORMATION

CORPORATE DATA

Name of Company : NIKKEN SEKKEI LTD
Registered Address : 2-18-3 Iidabashi, Chiyoda-ku, Tokyo, Japan
Founded : 1900
Established : July 1, 1950
Capital : 460 Million Yen

NUMBER OF PERSONNEL

Total : 3,329
Japan Registered 1st Class Architects : 1,321
Japan Registered 2nd Class Architects : 167
Nikken Group Total as of April 1, 2025

SYSTEM OF QUALITY CONTROL

NIKKEN SEKKEI established an in-house third party design review system for risk avoidance at each stage of design review. In 1997, Nikken Sekkei was the first Japanese design firm to obtain ISO registrations.

ISO 9001 : certified for quality assurance
ISO 14001 : certified for environmental management

Affiliated Companies

Nikken Group is a comprehensive professional consultancy group providing integrated service solutions for a large variety of planning, design and management. The group consists of the following companies.

NIKKEN SEKKEI RESEARCH INSTITUTE

URL www.nikken-ri.com/en/

Focusing on the fields of environment, energy and city management, conducting research, making policy recommendations and surveys, project and planning support services are provided.

NIKKEN SEKKEI CONSTRUCTION MANAGEMENT, INC.

URL www.nikken-cm.com/en/

Construction management incorporating advanced technology services throughout every stage of a construction project.

Disclaimer

No part of this publication may be reproduced in any manner whatsoever without prior permission in writing from the publisher. Nikken Sekkei Ltd is duly registered to provide professional services within Japan as Architects, Professional Engineers, Interior Designers, Landscape Architects, Urban Planners, Cost Planners, Project Managers and Construction Managers (collectively, the "Professionals"). All services provided by Nikken Sekkei Ltd, the Nikken Group and their related offices and corporations are offered and provided only in accordance with applicable laws and regulations. Nothing in this publication, including without limitation any reference to the Professionals or projects undertaken, shall be construed to mean or imply that Nikken Sekkei Ltd, the Nikken Group or any of their related offices or corporations supplies, or offers to supply, any services in any jurisdiction where such activities would be unlawful without registration with the local governing institution, body or authority.

Copyright © 2025 NIKKEN SEKKEI LTD
All rights reserved

OFFICE LOCATIONS

HEADQUARTERS

Tokyo Office
2-18-3 Iidabashi, Chiyoda-ku, Tokyo, Japan
Tel.+81 3 5226 3030
Fax.+81 3 5226 3052
Contact global@nikken.jp

MAIN OFFICES

Hokkaido, Tohoku, Nagoya, Osaka, Kyushu

OVERSEAS OFFICES

Contact global@nikken.jp
URL www.nikken.jp/en

SHANGHAI

6th Floor, Mangoo Hub Tower B, 7 Long Ai Road, Xu Hui District, Shanghai 200232, China
Tel.+86 21 5037 2265

DALIAN

5th Floor, Shenmao Building, 147 Zhongshan Road, Dalian 116011, China
Tel.+86 411 8364 8355

BEIJING

Room 1210, China World Tower 1, No.1 Jian Guo Men Wai Avenue, Chaoyang, Beijing 100004, China
Tel.+86 10 6505 4606

SHENZHEN

Room 1806, Shenzhen Metro Property Development Building, 6011-8 Shennan Avenue, Futian District, Shenzhen 518048, China
Tel.+86 755 8276 1105

CHENGDU

Room 2302, Building B, OCG International Center, 158 Tianfu Fourth Street, Chengdu City, Sichuan Province 610041, China
Tel.+86 28 8658 5530

SEOUL

2017, 92, Saemunan-ro, Jongno-gu, Seoul 03186, Korea
Tel.+82 2 568 4090

HANOI

Room 1706-A, 17th Floor, GELEX Tower, 52 Le Dai Hanh Street, Hai Ba Trung District, Hanoi City, Vietnam
Tel.+84 24 3715 3698

HO CHI MINH

Room 1004-A, 10th Floor, Zen Plaza Building, 54-56 Nguyen Trai Street, Ben Thanh Ward, District 1, Ho Chi Minh City, Vietnam
Tel.+84 28 3925 2570

BANGKOK

Room 705-706, 7th Floor, 11/1 AIA Sathorn Tower, South Sathorn Road, Yannawa, Sathorn, Bangkok 10120, Thailand
Tel.+66 2 285 1233

SINGAPORE (LIAISON OFFICE)

Room 17-00, Frasers Tower, 182 Cecil Street, 069547, Singapore
Tel.+65 6622 5330

DUBAI

NIKKEN SEKKEI FZ-LLC
Office A209, Building 6, Dubai Design District, Dubai P.O.Box 27120, UAE
Tel.+971 4 3434269

Dubai Branch

Office 2903, The Burj Al Salam Tower, Trade Center First, Sheikh Zayed Road, Dubai P.O.Box 27120, UAE